

# mice



**25h**  
dubai/one central  
twenty five hours hotel

# contents

- 3 overview**
- 4 packages**
- 7 first floor layout**
- 8 meeting room spaces**
  - 14 co-working space**
- 15 restaurant venues**
  - 20 cinema akil**
- 21 rooftop pool**
- 22 rooms**
- 24 event ideas**
- 26 directions**
- 27 contact**



# a place in the sun.

## overview

---

- 434 rooms & suites
- ue boom bluetooth speakers
- free high-speed Wi-Fi throughout the hotel
- spa & sauna
- gym
- hair salon & barber
- meeting rooms
- rooftop pool

## public areas

---

- 25hours things shop
- co-working
- tandoor tina restaurant
- monkey bar
- nomad day bar
- ernst biergarten
- juña rooftop shisha
- cinema akil



# conference packages

## basic package

included in each package

- \_ flip chart
  - \_ whiteboard
  - \_ moderator's toolkit
  - \_ free wifi
  - \_ writing pad
  - \_ pencil
  - \_ projector & screen \* OR
  - \_ led flat screen tv \*\*
  - \_ valet service
- 

## half-day package

until 12pm or 1–6pm (max. 5 hours)

- \_ basic package
  - \_ room rental
  - \_ tea station in the pantry room
  - \_ snack (either morning or afternoon)
  - \_ personal support during the conference
  - \_ lunch according to the chef's choice, including one soft drink
- 

## full-day package

- \_ basic package
  - \_ room rental
  - \_ welcome coffee
  - \_ tea station in the pantry
  - \_ lunch according to the chef's choice, including one soft drink
  - \_ break in the morning, incl. snack
  - \_ break in the afternoon, incl. snack
  - \_ personal support during the conference
- 

\* only in the meeting room 01, meeting room 02, meeting room 03, artist studio, wind and sand room.

# drinks packages

## conferences

### entry package

open alcoholic package

wine

- \_ atto primo
- \_ marius terret-vermentino
- \_ marius grenache syrah

beer

- \_ corona
- \_ heineken

spirits

- \_ ketel one
- \_ johnnie walker red
- \_ tanqueray
- \_ havana 3
- \_ el jimador

two cocktails

soft drinks

---

### premium package

open alcoholic package

wine

- \_ prosecco doc, alberto nani
- \_ upside down sauvignon blanc
- \_ d'arenberg the stump jump, grenache/syrah

beer

- \_ corona
- \_ heineken

spirits

- \_ grey goose
- \_ johnnie walker black
- \_ hendricks
- \_ bacardi 8
- \_ patrón silver

two cocktails

soft drinks

---

make a  
wish.



**25h**

dubai/one central  
twenty five hours hotel

# first floor layout

7



## overview

25hours Hotel One Central is conveniently located a stone's throw from Dubai International Financial Centre, right beside Dubai World Trade Centre.

With a bright, airy, industrial feel, our event spaces provide the perfect setting for creative thinking, productive discussions, or special occasions.

All rooms feature plenty of modern tech, 5-meter-high ceilings, and huge windows so you can enjoy the breathtaking views.

A fully kitted co-working space, open pantry and coffee bar are also available at the gallery on the first floor.

We challenge you to challenge us!

# meeting room 1



## overview

With views across to The Museum of The Future, Meeting Room 1 is the ideal space to inspire your company's progression. Along with huge windows and industrial ceilings, the room features a bolted central table, ideal for co-working and brainstorming. The room conveniently interconnects with the steam room; a playful environment complete with a trampoline, ball pit, ropes + rings - surprise your team with the most creative breakout session they've ever had!

## facts

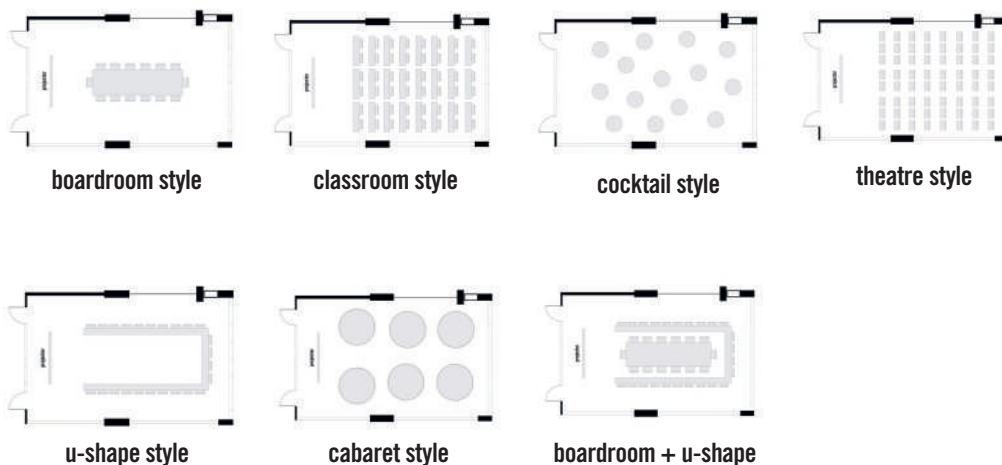

size	room capacity [max. capacity]	facilities
— 126 sqm	<ul style="list-style-type: none"><li>— boardroom [18 people]</li><li>— classroom [30 people]</li><li>— cocktail style [50 people]</li><li>— theatre style [70 people]</li><li>— u-shape [20 people]</li><li>— cabaret [60 people]</li><li>— boardroom + u-shape [44 people]</li></ul>	<ul style="list-style-type: none"><li>— 75" smart tv</li><li>— high-speed wi-fi</li><li>— projector</li><li>— view of the museum of the future</li><li>— multimedia station</li></ul>



# meeting room 2



## overview

Identical to Meeting Room 1, Meeting Room 2 keeps things simple - great views, plenty of space and a large bolted table for co-working brainstorming or presenting your finest collateral. The room oozes natural daylight thanks to a set of huge windows. Besides the room you will find 6 bedouin style phone tents - for when you need to escape the meeting to take a private call.

## facts

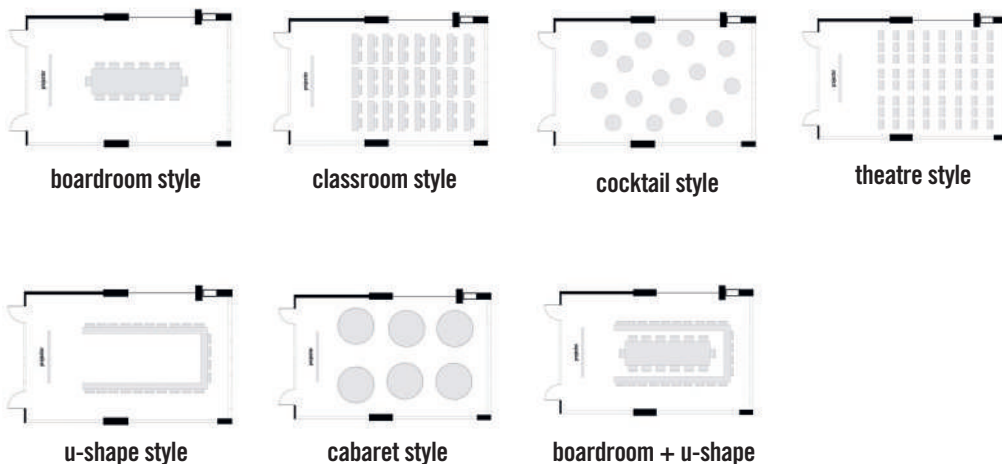

size	room capacity [max. capacity]	facilities
— 126 sqm	— boardroom [18 people] — classroom [30 people] — cocktail style [50 people] — theatre style [70 people] — u-shape [20 people]	— 75" smart tv — high-speed wi-fi — projector — view of the museum of the future — multimedia station

# meeting room 3



## overview

With exposed ceilings and a bolted central table ideal for brainstorming, Meeting Room 3 is the ideal venue for events followed by creative experiences. Brimming with natural daylight thanks to the huge windows, the addition of an inter-connecting Artists Studio makes this room a perfect space to exhibit your teams' finest achievements or close the day with a spontaneous drinks reception.

## facts

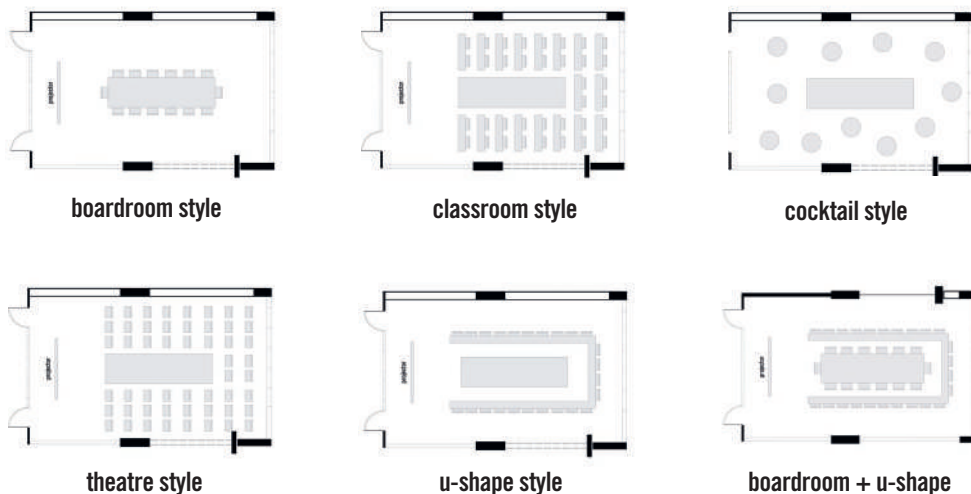

size	room capacity [max. capacity]	facilities
– 126 sqm	– boardroom [18 people] – classroom [25 people] – cocktail style [40 people] – theatre style [50 people] – u-shape [20 people] – boardroom + u-shape [44 people]	– 75" smart tv – high-speed wi-fi – projector – view of the museum of the future – multimedia station

# wind room



## overview

A lofty industrial space draped in fabric giving a nomadic tent-like feel. The room features hanging seats suspended over the sand pit and numerous fans to keep you cool. Whatsmore, the room connects to the pottery studio and has spectacular views of The Museum of the Future from its floor-to-ceiling windows. Ideal for fun parties, events and creative meetings.

## facts

size	room capacity [max. capacity]	facilities
— 150 sqm	<ul style="list-style-type: none"><li>— boardroom [20 people]</li><li>— classroom [40 people]</li><li>— cocktail style [100 people]</li><li>— theatre style [80 people]</li><li>— u-shape [30 people]</li><li>— cabaret [40 people]</li></ul>	<ul style="list-style-type: none"><li>— 75" smart tv</li><li>— high-speed wi-fi</li><li>— sand box</li><li>— swing</li><li>— view of the museum of the future</li></ul>



classroom style



cocktail style



theatre style



u-shape style

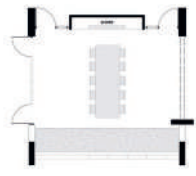

boardroom style

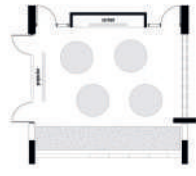

cabaret style

# sand room



## overview

Same as Wind Room. A highly flexible space with no fixed setup, huge windows and a tented ceiling - so you feel like a true nomad. The room also features a sandpit - ideal for building castles, playing pétanque or gentle exfoliation during DDR breaks. For daydreamers: the sand room has among the most breathtaking views of The Museum of the Future and Emirates Towers which make it also an ideal space for candle-lit dinner parties. For extra capacity it can also be joined with the Wind Room.

## facts

size	room capacity [max. capacity]	facilities
— 180 sqm	<ul style="list-style-type: none"><li>— boardroom [20 people]</li><li>— classroom [40 people]</li><li>— cocktail style [100 people]</li><li>— theatre style [80 people]</li><li>— u-shape [30 people]</li><li>— cabaret [40 people]</li></ul>	<ul style="list-style-type: none"><li>— 75" smart tv</li><li>— high-speed wi-fi</li><li>— sand box</li><li>— swing</li><li>— view of the museum of the future</li></ul>



classroom style



cocktail style



theatre style



u-shape style

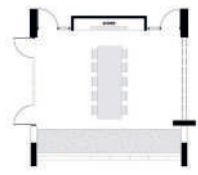

boardroom style



cabaret style



# wind & sand room



## overview

The Wind & Sand Room offers a unique and highly flexible space that combines the best features of two distinctive areas to create an exceptional environment for meetings, events, and creative gatherings. This expansive room merges the serene ambiance of the Sand Room with the dynamic atmosphere of the Wind Room, providing an unparalleled experience for all attendees.

## facts

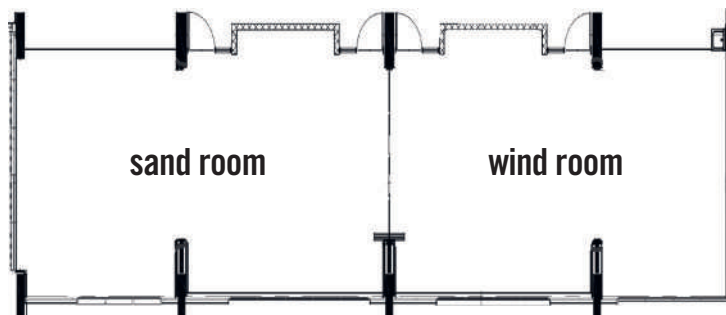

size	room capacity [max. capacity]	facilities
— 330 sqm	— classroom [60 people] — cocktail style [130 people] — theatre style [150 people] — u-shape [60 people] — cabaret [70 people]	— 75" smart tv — high-speed wi-fi — sand box — swing — view of the museum of the future



# co-working



## overview

Co-working space and coffee bar are also available at the gallery on the first floor.

With a bright, airy, industrial feel, our spaces provide the perfect setting for creative thinking and productive discussions.

## facts

size	room capacity [max. capacity]	facilities
— 189 sqm	— seating: 80 people — standing: 80 - 100 people	— high-speed wi-fi — bar / cafe island — view of lobby

# tandoor tina



## overview

Tandoor Tina celebrates fresh, high-quality ingredients, bold, bright flavours and specialises in cooking over fire on the grill and tandoor oven. Inspired by a journey through India, the restaurant revives the smells, tastes and colours of exotic and carefree travels - with a year-round summer mood. The restaurants interiors feature Jaipur pastel pink hues, wicker lights and luscious botanicals, while the terrace is a secluded tropical garden complete with ample seating and al fresco kitchen.

## facts

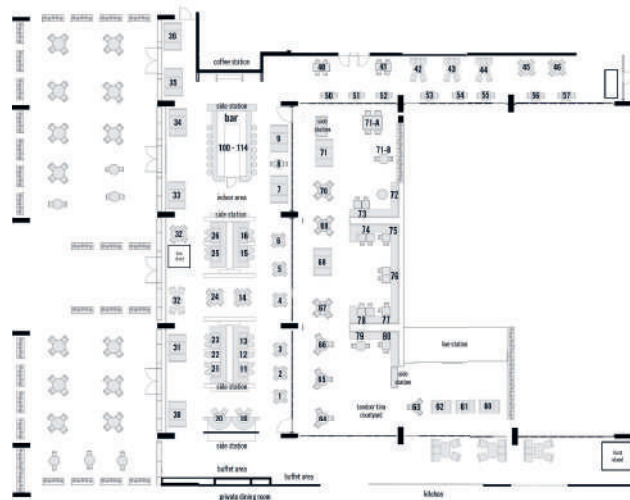

size	room capacity [max. capacity]	facilities
— indoor: 278 sqm	— indoor seating: 100 people	— high-speed wi-fi
— terrace: 29.5 m x 8.40 m	— bar seating: 14 people	— direct daylight
	— private dining room: 12 people	— air conditioning
	— terrace seating: 94 people	

# ernst biergarten



## overview

Ernst is a Bavarian Biergarten & Wirtshaus serving a variety of German beers on draught, Dubai's best Weisswein, and house-baked pretzels. A home for sport; Ernst shows live matches from around the world across multiple screens. With a seating capacity of up to 400 guests (indoors and outdoors) Ernst will feature regular live entertainment, quiz nights and seasonal specials. A private dining room can accommodate up to 20 for a true banquet.

## facts

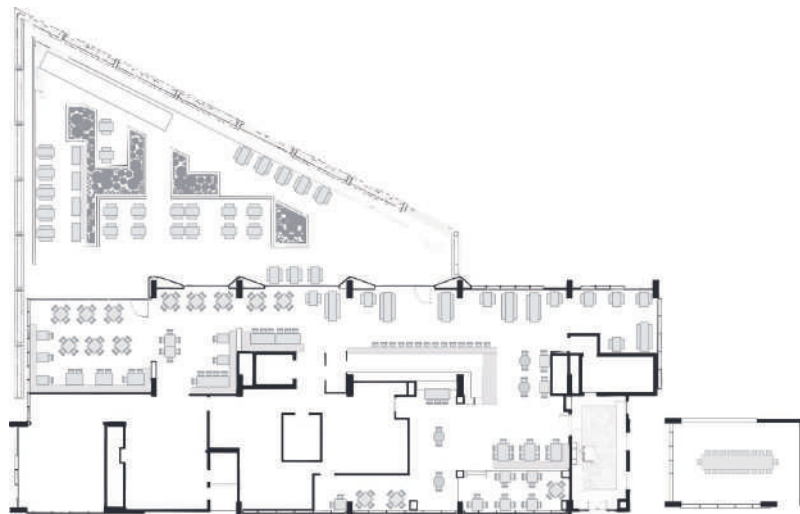

### size

- \_ indoor: 500 sqm
- \_ terrace: 445 sqm

### room capacity [max. capacity]

- \_ indoor seating: 400 people
- \_ private dining room: 23 people
- \_ terrace seating: 200 people

### facilities

- \_ 75" smart tv
- \_ high-speed wi-fi
- \_ direct daylight
- \_ air conditioning



# nomad day bar



## overview

Nomad Day Bar offers a diverse selection of seating options, both indoors and outdoors, making it an ideal venue for various gatherings such as meetings, events, and brand launches. Operated by the award-winning Nightjar Coffee Roasters, it serves artisanal and specialty coffee, including cold brew nitro coffee, flavoured nitro iced tea, fresh juices, soft drinks, and alcoholic beverages. The perfect place for a quick caffeine boost or to relax, it's a hive of activity and an ideal meeting spot.

## facts

size	room capacity [max. capacity]	facilities
<ul style="list-style-type: none"><li>indoor: 197 sqm</li><li>courtyard: 718 sqm</li></ul>	<ul style="list-style-type: none"><li>courtyard seating: 94 people</li><li>indoor seating: 100 people</li></ul>	<ul style="list-style-type: none"><li>high-speed wi-fi</li><li>direct daylight</li></ul>

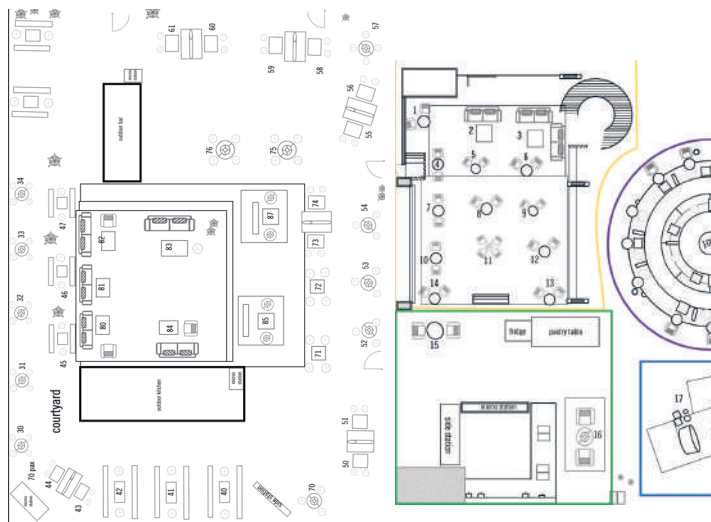

# monkey bar



## overview

Monkey Bar is Dubai's most exciting cocktail bar, perched on the sixth floor of 25hours Hotel One Central. The rooftop bar has indoor and terrace seating suitable for nightlife and corporate events. The bar boasts impressive views of the Museum of The Future and Zabeel Park while the terrace - complete with monkey cages for groups - is perfect for sundowners.

## facts

size	room capacity [max. capacity]	facilities
<ul style="list-style-type: none"><li>indoor: 120 sqm</li><li>terrace: 430 sqm</li></ul>	<ul style="list-style-type: none"><li>indoor seating: 75 people</li><li>terrace seating: 250 people</li></ul>	<ul style="list-style-type: none"><li>high-speed wi-fi</li><li>direct daylight</li><li>view of the museum of the future</li><li>sound system</li></ul>

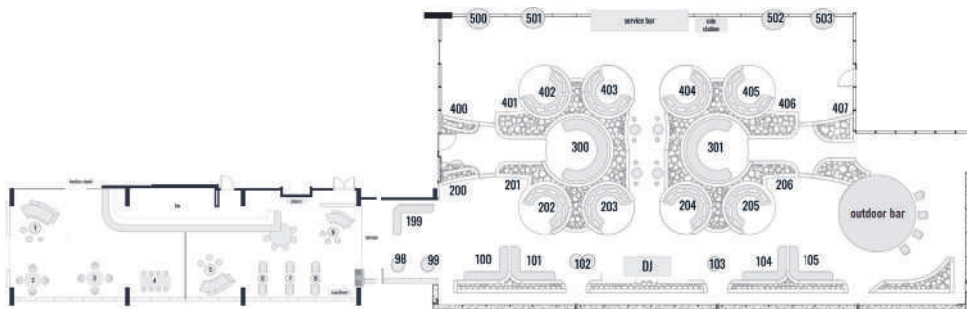



# juña rooftop shisha



## overview

Discover Juña's rooftop shisha garden on the 6th floor, a sanctuary inspired by bohemian mystique. Beneath the starry night, the setting invites you to relax, savor drinks, enjoy a meal, or simply unwind with shisha while taking in the breathtaking view of the Museum of the Future. The garden ambiance is enhanced with cozy boho-chic elements — Persian carpets, plush couches, and leather poufs, all harmoniously blending tribal influences.

## facts

size	room capacity [max. capacity]	facilities
— 272 sqm	— terrace seating: 70 people	— high-speed wi-fi — direct daylight — view of the museum of the future

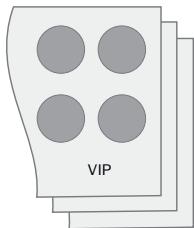
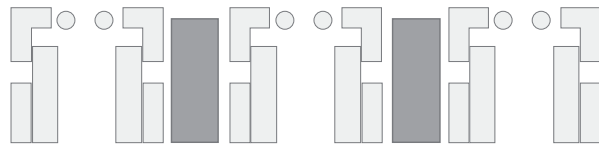

# cinema akil



## overview

Cinema Akil in 25hours, nestled in the heart of 25hours Hotel in One Central Dubai redefines cinematic and cultural experiences. Located on the ground-level outdoor atrium of the 25hours hotel, this seasonal outdoor outpost, operating from November to May, is accessible from both the hotel lobby and One Central. The multi-faceted space is divided into three sections: the box office/concession area, the open cinema theatre, and a versatile retail/pop-up space. More than just a cinema, it offers a dynamic array of entertainment options, including F&B, music events, talks, and pop-up experiences.



## facts

size	room capacity [max. capacity]	facilities
<ul style="list-style-type: none"><li>— 486 sqm</li><li>— 10.5 x 8.2 x 3.1 m (l x w x h)</li></ul>	<ul style="list-style-type: none"><li>— standing reception: 100 - 150 people</li><li>— seating: 72 people</li></ul>	<ul style="list-style-type: none"><li>— high-speed wifi</li><li>— audio system</li><li>— cinema screen</li><li>— bar</li><li>— marquee sign, poster boxes, theatre seats</li></ul>

# rooftop pool



## overview

Located on the 6th floor, the rooftop pool offers stunning views of Dubai's city skyline, especially the Museum of the Future.

Event set-up starts at 5pm.

## facts

size	room capacity [max. capacity]	facilities
_ terrace: 827 sqm	_ terrace seating: 42 people	<ul style="list-style-type: none"><li>_ high-speed wi-fi</li><li>_ direct daylight</li><li>_ pool bar</li><li>_ view of the museum of the future</li></ul>

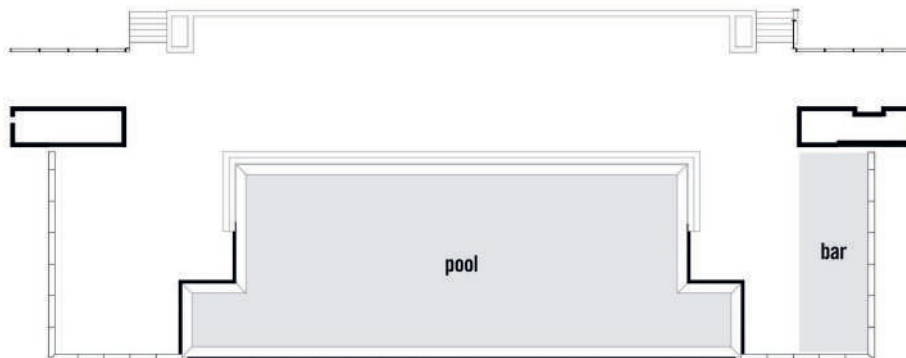



# rooms

## bedouin room

- \_ 30 sqm
- \_ king bed
- \_ smart tv
- \_ rain shower
- \_ canvasco bag
- \_ bluetooth speakers
- \_ schindelhauer bikes
- \_ free high-speed wi-fi
- \_ air conditioning
- \_ pets allowed
- \_ non-smoking



## glamping room

- \_ 36 sqm
- \_ king bed
- \_ smart tv
- \_ rain shower
- \_ in room bathtub
- \_ canvasco bag
- \_ bluetooth speakers
- \_ complimentary schindelhauer bikes
- \_ free high-speed wi-fi
- \_ air conditioning
- \_ pets allowed
- \_ non-smoking



## farmstay suite

- \_ 50 sqm
- \_ king bed
- \_ smart tv
- \_ double rain shower
- \_ in room bathtub
- \_ hammock
- \_ canvasco bag
- \_ bluetooth speakers
- \_ complimentary schindelhauer bikes
- \_ free high-speed wi-fi
- \_ air conditioning
- \_ pets allowed
- \_ non-smoking



# rooms

## artist village suite

- \_ 72 sqm
- \_ king bed
- \_ smart tv
- \_ double rain shower
- \_ in room bathtub
- \_ canvasco bag
- \_ bluetooth speakers
- \_ private schindelhauer bikes
- in-room
- \_ free high-speed wi-fi
- \_ air conditioning
- \_ pets allowed
- \_ non-smoking



## hakawati suite

- \_ 228 qm suite + 52 qm balcony
- \_ sheikh size bed (triple king bed)
- \_ double bath tub
- \_ hammock
- \_ 2 private bars with dancefloor
- \_ private sauna
- \_ fireplace
- \_ air conditioning
- \_ bluetooth speaker
- \_ smart tv
- \_ canvasco bag
- \_ in-room schindelhauer bike
- \_ non-smoking
- \_ pets allowed
- \_ and much more...





# event ideas

## pop-up

The patterns have been returned to the drawers, the sewing machine is now gathering dust. And the most important thing: The first collection is ready to wear. Before you take it to Milan, Paris, or London, how about your own pop-up at one of our 25hours Hotels? Even the biggest designers started small and unconventionally and presented their pieces to the public. Or is there a new product launch in the pipeline? Thanks to our locations in the major cities in Germany, Austria, and Switzerland, the potential customer base is already present and won't miss your pop-up.



## press conference

Your press appearance really needs to make waves? To do this, not only the product has to be right, but also the venue. At our 25hours Hotels in Germany, Austria, and Switzerland, we offer personalised solutions for the perfect setting. Classic conference rooms with seating, cosy lounges with a fireplace or a panoramic view over the city - whatever suits your product or target groups best, we'll work together to host the perfect press conference.



## product launch

From lip balm, to the new novel series, right up to sports cars packed with horse power - good ideas need effective launches in order to have a successful start on the market. The 25hours locations are as diverse as the products unique. Be it big and grandiose or cosy and small - do you already have a brilliant idea and your breakthrough is within reach? Maybe you still need a little inspiration.



## assessment centre

Let's get down to business. Which of the applicants is potentially the right candidate for a management role? Individual or group assessments, management audits, or an evaluation assessment centre - when discretion has the top priority, we're the right choice. Even just for a cosy get-together at one of our restaurants or bars - there is a personalised solution for all kinds of requests. And the possibilities are endless at the 25hours Hotels.



# event ideas

## album release

The new album: Check! The big day is here. Now, the big wide world should listen and recognise the true artistry. We have exactly the right locations for this - be it cosy and intimate or big and fabulous. For twenty, a hundred, or even hundreds of listeners. With a live set or a sound system with bass tubes and the perfect sound. We even have instruments available on site at some hotels. Just do your thing and win the audience over with your new album. We have everything you need and the perfect spaces for a flawless release party.



## casting

Your company is in its infancy and your new offices aren't ready yet? We would be happy to provide our rooms for castings and recruitment interviews. Whether it's on a small scale or somewhat larger. Be it individual hotel rooms, the lobbies, bars, or restaurants - we have the right venue for any casting event. Just click through to have a look or come and visit us in person. Many rooms can be adjusted as required to meet your exact needs.



## fotoshooting

The new lookbook for the coming season needs to be shot? The next edition of the magazine has a feature on Berlin? Zurich or Hamburg? The photographer is booked, but the matter of the right location hasn't been resolved? Our 25hours Hotels, with their individual hotel concepts, offer tailored spaces for photoshoots with a passion for detail. Whether it's in a bathtub with a view over the Vienna MuseumsQuartier, on the roof terrace at the 25hours Hotel Bikini Berlin with a view of chimpanzees and elephants, or in the colourful, urban world of the 25hours Hotel Frankfurt The Goldman in Frankfurt's east end. Our hotels are as diverse as the fashion and culture themselves.



# directions



## arriving on public transport

25hours Hotel One Central is located right next to the World Trade Center station on the red line of Dubai metro. From the airport hop on the trains in direction of EXPO 2020 and get off at World Trade Center, from there it's 800m walk for approx. 9 minutes.

## arriving by car

Arrive and drop your keys with our valet service or head to our underground parking which can accommodate around 450 vehicles.

# contact

**25hours Hotel One Central**  
Trade Centre Street, off Sheikh Zayed Road  
PO Box 9895  
Dubai, UAE

**General contact:**  
[onecentral@25hours-hotels.com](mailto:onecentral@25hours-hotels.com)  
+971 4 210 2525

**For room reservations:**  
[res.onecentral@25hours-hotels.com](mailto:res.onecentral@25hours-hotels.com)